

# Coolabah Park

Championship Qualifier

Grovedale, Thursday 13/2/20



0 50 150 250 350 450 500

SCALE 1:10,000

Contour Interval: 10 metres

Start/Finish at Coolabah Park  
EMERGENCY PHONE NUMBER: 0427 777 061

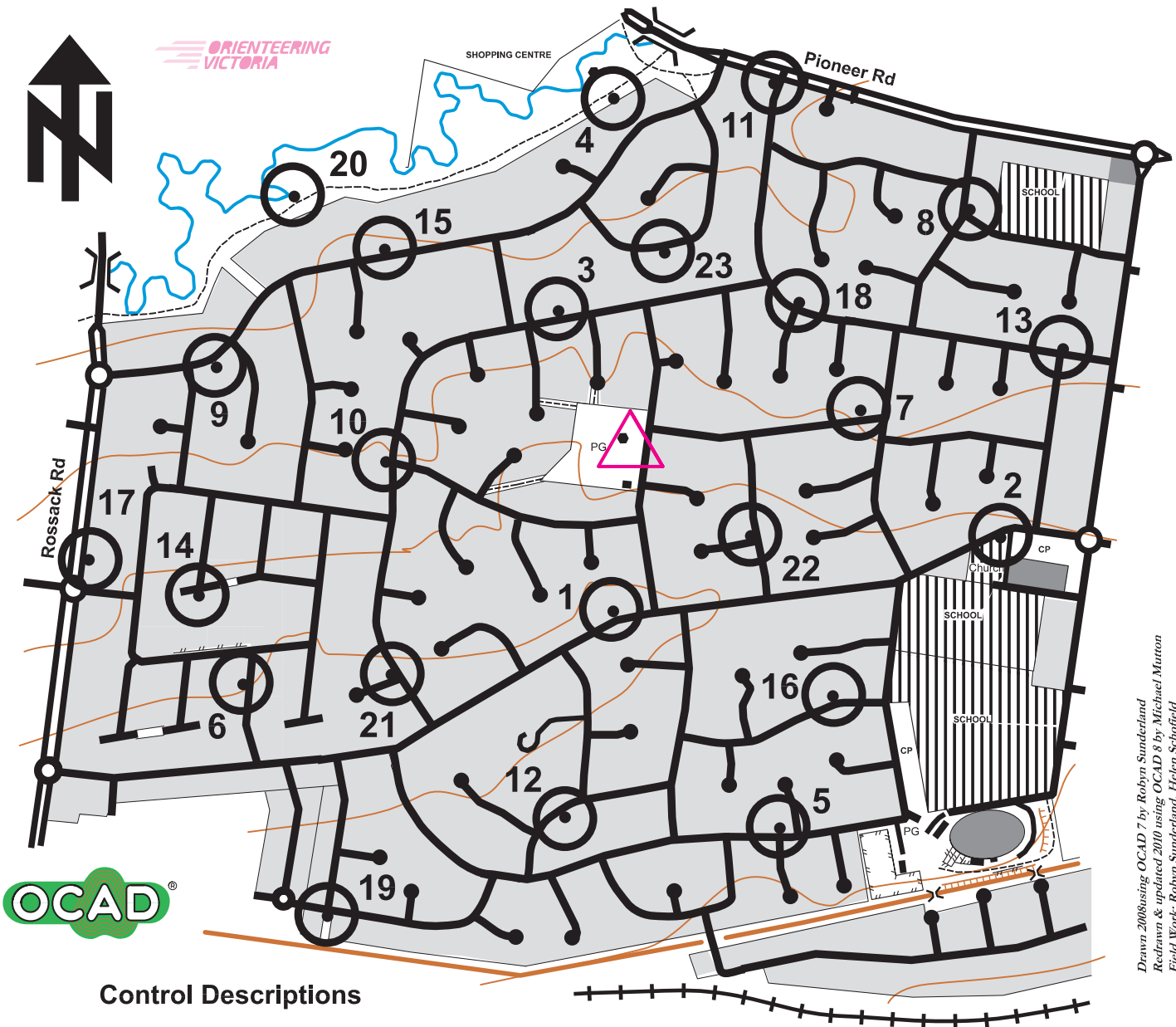

Drawn 2008 using OCAD 7 by Robyn Sunderland  
 Redrawn & updated 2010 using OCAD 8 by Michael Marston  
 Field Work: Robyn Sunderland, Helen Schofield

## Control Descriptions

- |                       |                                    |
|-----------------------|------------------------------------|
| 1. Bush at #142       | 11. Give Way sign                  |
| 2. Street Light       | 12. Bush at #19                    |
| 3. Bush at #36        | 13. Power Pole                     |
| 4. Tree (opp Rotunda) | 14. Street Light                   |
| 5. Street Light       | 15. Tree at #48                    |
| 6. Street Light       | 16. Small tree at #10              |
| 7. Tree at #6         | 17. Electricity access hole at #71 |
| 8. Power Pole         | 18. FP access at #56               |
| 9. Tree at #75        | 19. Gate                           |
| 10. Street Sign       | 20. Small Gum Tree                 |
| 21. Street Sign       | 22. Street Sign                    |
|                       | 23. FP access                      |

## Courses

A grade 21/23	9.4km
B grade 18/23	7.4km
C grade 13/23	5.7km
D grade 9/23	3.9km

## Power Walkers

1 - 5	2 points
6 - 10	3 points
11 - 15	4 points
16 - 20	5 points
Return by 8.05 pm	
Late return penalty 3 points per minute or part minute	